



Schindler high-rise solutions

Innovating for the future

We Elevate



Schindler

Smart sustainable urban spaces

Around the globe, we provide smart and eco-friendly vertical mobility solutions to keep cities moving.

Combining innovation and sustainability, our state-of-the-art high-rise offerings guarantee an optimal flow of people and goods and efficiently connect vertical and horizontal transportation systems.

People-focused

Our products and services are designed by people for people – and that makes all the difference.

Safety first

Keeping our passengers, customers, and employees safe always comes first.

Sustainability

Through technology and innovation, we are helping to build greener and more livable cities.

Customization

Each solution is tailored to your needs.

Efficiency

From start to finish, we manage space, time, and economic operations effectively and efficiently to ensure the project runs smoothly.

Reliability

More uptime, fewer disruptions.

Experience

As an experienced and passionate partner, we help your vision become a reality.



Shaping sustainable cities Forward-looking responsibility

We are at the forefront of developing sustainable and smart urban mobility, playing a critical role in making cities more people centric, inclusive and greener – enhancing the quality of life for current and future generations.

Our commitment

We are committed to reducing our environmental impact throughout our entire value chain and product life cycle – we are already a signatory to RE100 and we have pledged to be:

- Net zero by 2040, targets approved by SBTi
- Transition to 100% renewable energy by 2025
- Contribute zero hazardous waste to landfill by 2023

Our products focus on energy efficiency

Through investing in research and development, each new generation of our products is more energy efficient than the previous one.

All of our elevators and escalators are optimized for weight and equipped with various features such as Eco Mode, regenerative drives and LEDs to reduce energy consumption.

Our Schindler PORT smart dispatch technology can provide energy savings of up to 40% – doing more with less elevators.

We are constantly working to reduce Greenhouse Gas (GHG) emissions

Our green maintenance contracts (combining remote maintenance with EV fleet) lead to a 99.5% reduction in GHG emissions, as certified by leading testing and certification agency TÜV.

Our 200,000 plus connected units allow for remote monitoring and maintenance, reducing the number of times our technicians need to travel.

These connected units have already helped to reduce callouts by up to 40%, compared to non-connected units, lowering our service fleet's fuel consumption and carbon footprint.



Supporting the 2030 Agenda for Sustainable Development
We support the 2030 Agenda for Sustainable Development, as well as the Paris Climate Agreement. We have identified six United Nations Sustainable Development Goals (UNSDGs) where we can have the most impact – but we contribute to more.





Cyber resilience across the organization Secure living in a connected world

We innovate to keep people moving safely and conveniently. Our elevators and escalators have evolved to become smart, connected systems that can be remotely monitored. Security strategies, tactics, and patterns are all considered at each stage of our product lifecycle to ensure cyber resilience and first-class security.

We focus on two key, interconnected areas to ensure cyber security: “product security” and “enterprise cyber resilience.”

Product security

Our products are increasingly connected with the ability to exchange data thanks to embedded sensors and software. To minimize the risk and exposure to security threats, we have embedded security architecture into our product design, while using threat-modelling to identify security risks and define appropriate countermeasures.

Enterprise cyber resilience

We design and implement cyber-resilient practices and capabilities across our organization. This includes business continuity governance for continuous business services and applications while guaranteeing data confidentiality. In addition, state-of-the-art security monitoring systems help to assist in identifying potential cyber risks.

Building Information Modeling (BIM)

Unlock the potential of your building

An intelligent model-based process, BIM (Building Information Modeling) provides traceability and insights throughout the project life cycle, including planning, design, construction, operation, maintenance, and modernization.

How we ensure your next project is a success

 BIM Models in Level Of Development (LOD) 300, 350 and 500

 Fully integrated building models in the overall construction process achieve smooth design coordination and project transparency

 Seamless exchange of data throughout the project life cycle (from design to modernization)

 Potential to integrate information for standard and customized assets in all elevators and escalators

 Support for construction site management and activities using BIM models

 Schindler R.I.S.E works with BIM to help complete the installation process faster and to a higher quality standard



With faster, clearer design plans, less alterations are required on-site. Saving time, energy, and materials – further helping to enhance sustainability.

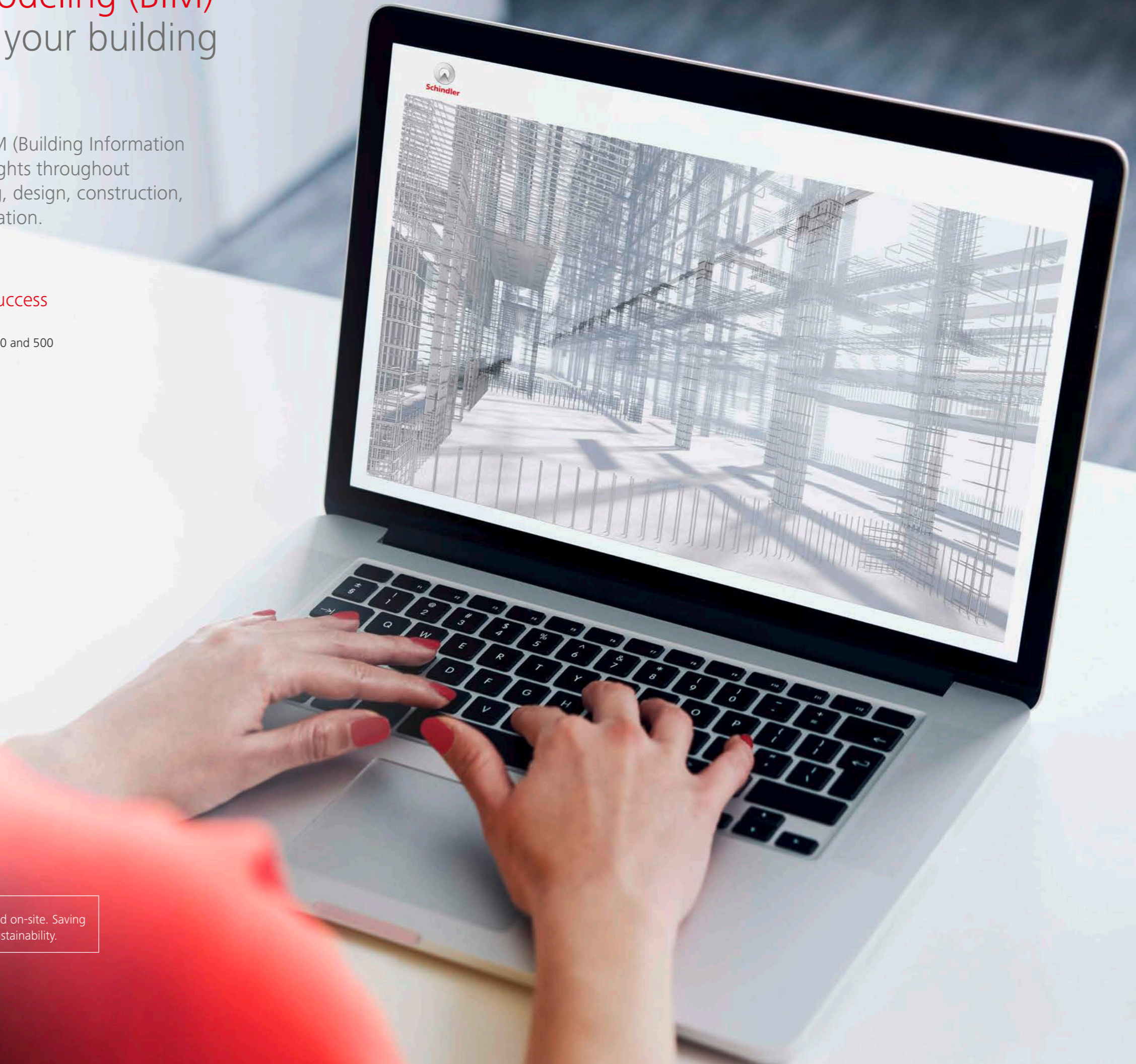

Our high-rise approach

Projects that are more than buildings

Our innovations allow for the optimal flow of people and goods required to let your project thrive.

By working with your project team, we can provide the best, tailor-made solutions for your high-rise building.

Even after project completion, we continue to support and partner with you throughout the entire life cycle of the building.



The Schindler high-rise life cycle

From design to the skyline

We work with you along every stage of your high-rise life cycle: from design to installation, all the way through to operation, maintenance and modernization.



Phase **Design**

"Bringing function and form to life"



Phase **Operate & Maintain**

"Optimizing the stream of people and goods"



Phase **Install**

"Pioneering new building methods"



Phase **Modernize**

"Revolutionizing performance with intelligent engineering"





Phase **Design**

Bringing function and form to life

We are with you from the beginning. Before breaking ground, our team of experts can assist you in optimizing your project during the design phase. Our philosophy is to listen and work with you, to supply the perfect solution for your specific needs – helping to deliver your vision from plans to reality.



Design – traffic simulation

Understanding your needs

Our traffic analysis and simulations run multiple scenarios to determine the approach for your specific requirements. Based on a huge database of traffic patterns and custom-made algorithms, we can provide a reliable demonstration and key insights into the flow of traffic through a building before it has even been built – providing comprehensive support from planning to final implementation.

Our traffic planning tool can assess a building and its future requirements in a level of detail and accuracy that is unique, covering:

- The entire building and all its floors
- The type of usage and number of users on each floor
- The full range of passenger demands
- The equivalent of hundreds of days of use to provide a reliable prediction of the building performance

Our traffic analysis reports document the proposed solutions and provide accurate answers to what a user can expect in different traffic situations:

- How long will a passenger wait for an elevator on average?
- How long does the entire journey take, from calling the elevator to arriving on the destination floor?
- While traveling in an elevator, how many intermediate stops will a passenger experience on average?
- How likely is it to experience long waits for an elevator, i.e., more than 90 seconds?

Results of the traffic simulation

Elevator arrangement

The number of elevators and their arrangement in groups, and which floors are served by which elevators. An intelligent arrangement of hoistways improves space efficiency and can prepare a building for future adaptations.

Traffic management system

The advanced algorithm powering Schindler PORT fully optimizes the way elevators are assigned to take passengers to their destinations.

Single-deck or double-deck

Double-deck elevators can carry up to twice as many passengers as single-deck elevators in the same shaft. Combined with Schindler PORT, this can be a game changer for your building.

Car size, speed, and door type

Selecting the optimal car size, nominal speed, and door type ensures that the system perfectly meets the requirements while minimizing the space and energy needed.

Design – elevator cars

The best choice for any requirement

For high-rise projects, we offer a range of possibilities for elevator cars. Ensuring that we can provide the best choice of technical design for your building.

Convenient space saving possibilities

In addition to the **single-deck** elevators, which have proven themselves in the market over many years, we also provide the **double-deck** elevators. They are ideal for high occupancy buildings where space is increasingly limited. We take into consideration how to optimize the space in your building without compromising on the traffic stream. The aim is to maximize your rentable floor space by minimizing the footprint of the elevators and hoistways.

When it comes to occasional transportation of heavy goods, a Schindler **Dual Load** elevator is highly recommended. This solution integrates two different operation modes in one elevator, combining the advantages of both: In daily operation it functions as a passenger/service elevator. When needed, it can be switched into the heavy-duty transportation mode. This innovative installation leads to more rentable space, lower costs and reduced energy consumption.

Optimization of space by reducing the number of hoistways with the same number of cars



Rentable space with single-deck elevators



Rentable space with double-deck elevators



Schindler Sustainability

Our high-rise products for commercial and residential buildings can achieve energy class A according to ISO 25745.

Schindler's car variations for high-rise buildings

Single-deck

We operate in the high-rise market with well-known, high-quality single-deck elevators. The technology is constantly being further developed and adapted to increasingly demanding requirements.

Double-deck

With the double-deck solutions, another significant improvement has been made: Double-deck elevators are now available as a standard option in the modular Schindler 7000 elevator system. Intelligent engineering and advanced Transit Management systems are key. Double-deck elevators operate almost identically to single-deck, but with a doubled capacity.

Adjustable Double-deck

The adjustable double-deck is able to adjust to uneven floor to floor distances by changing the position of one of the cars according to a defined adjustment range. This can be suitable for buildings with a high lobby and smaller common floors, or for modernization projects (from single-deck to double-deck) in buildings, that may not have an equal floor to floor distance.

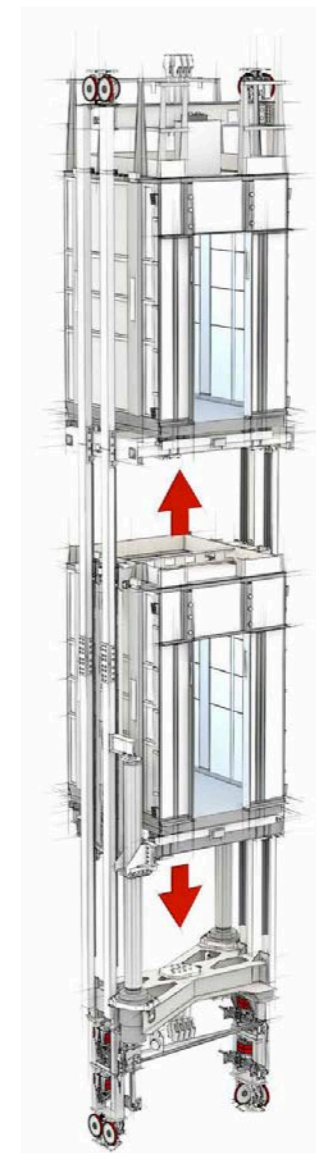

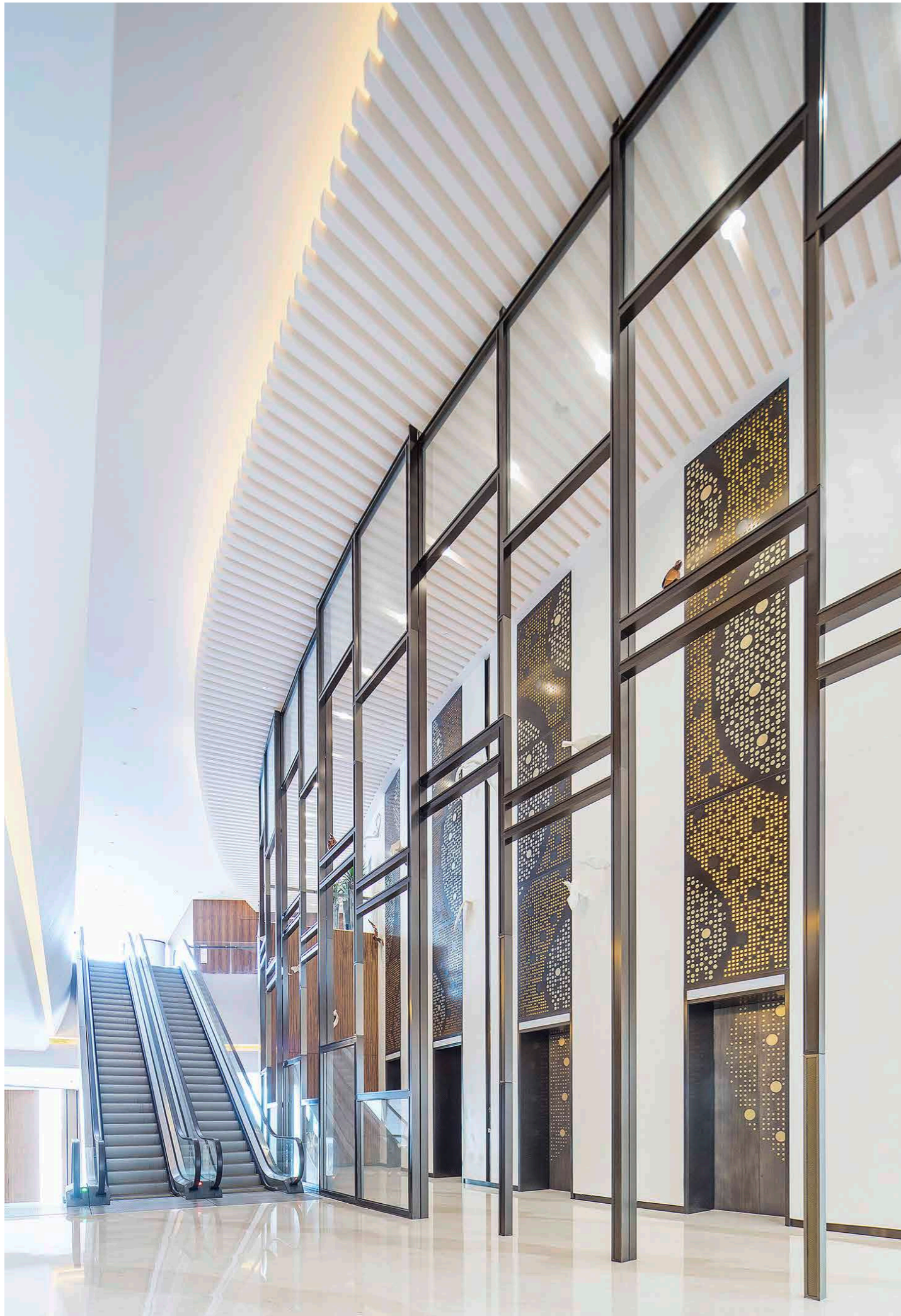

Design – style and esthetics

Limitless creativity

Your lobby, your style! Elevators are striking architectural elements. They determine the impression the interior of the building makes, at first glance, right when you enter the lobby. Our high-rise elevators blend independently but harmoniously into the overall building concept.

You are invited to choose among two different approaches of freedom in creativity. On the one hand, “the customization approach”, which guarantees absolute design freedom. On the other hand, “the standard approach”, where you can choose a specific style from a product line of trendy decorations.

You can create an individual design for each elevator car by selecting different materials, shapes, and colors for the following elements:

- Ceiling and lighting
- Wall cladding
- Operating panels
- Floor
- Accessories (mirrors, handrails, etc.)
- Various digital media services
e.g. SmartMirror, DoorShow etc.)

We offer a wide range of landing doors, to perfectly connect the inside and the outside. Each landing door has a unique visual appearance. When it comes to attractive styles, we are your professional partner for a perfect combination of esthetics, functionality, and safety.

In compliance with local elevator standards, all these elements can be combined to create a car atmosphere that reflects your design ideas and complements the building.

Pioneering new building methods

High-end project management and comprehensive fulfillment skills as well as the most innovative, sustainable, and digital installation methods ensure maximum installation excellence for your projects. All this is underlined by our new, cutting-edge eFulfillment tools.



Install – TREN and installation excellence

Striving for efficiency and the highest quality

Top Range Excellence (TREN)

TREN sets out the processes, tools and rules that collectively form the large project management and controlling framework. Specifically devised to manage large project, in order to achieve: the best financial results; reduce the commercial and legal risks; deliver quality handover to project manager; and ensure highly-satisfied customers.

TREN strengthens market leadership in the high-rise business as well as increasing the profitability of high-rise projects. TREN stands out in three dimensions:

1st dimension

The business process for large projects is structured into five main phases and leads

to strategic readiness: Sales > Sales to fulfillment > Pre-site > Site execution > Handover

2nd dimension

Quality checks and Hold Point to ensure the highest quality standards in each of the five steps.

3rd dimension

Human Capital Readiness (HCR), designed to deliver all the necessary elements to provide a first-class service. The training and certification program focuses on having well-trained and certified professionals on site for a seamless and accident-free execution.

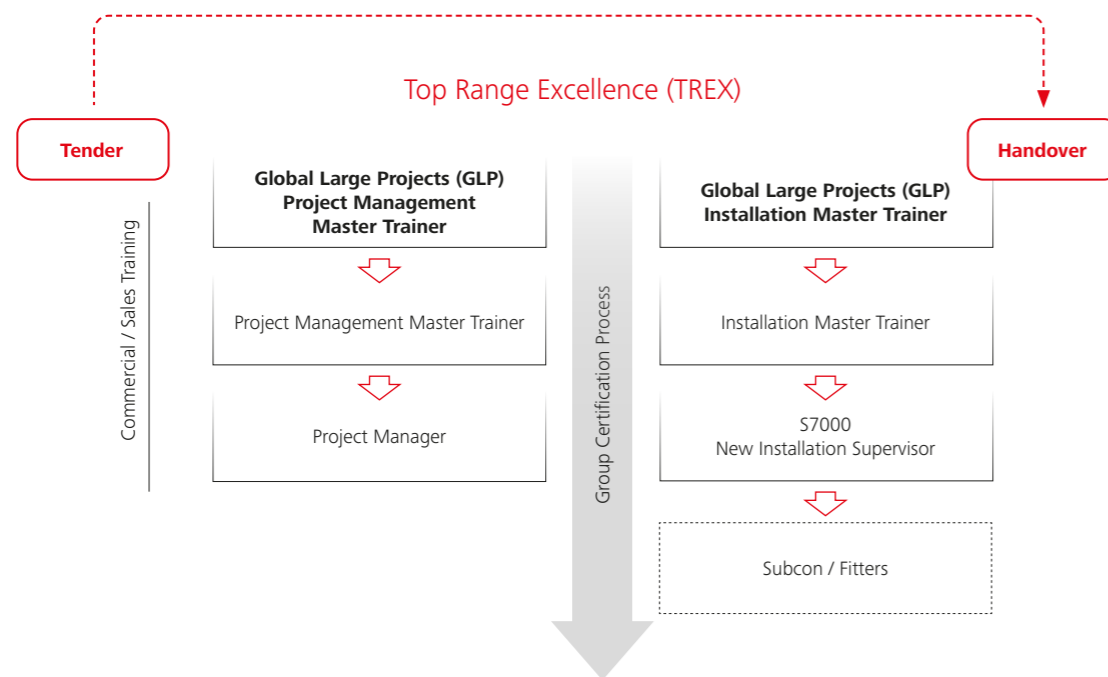

Customer benefits

- Master trainers (acting worldwide)
- Certified project managers and Schindler 7000 new installation supervisors
- Worldwide presence of specialized fulfillment teams
- Independent SAIS inspectors (SAIS: Schindler Acceptance Inspection Standard)
- Training centers all over the world

The new eFulfillment tools

The following tools serve to continually improve our level of execution:

Information to the Field (ITF)

ITF enables Schindler fitters and subcontractor fitters to always have access to updated Embedded Documents (EMBDs) via their mobile devices. The tool makes it easy for the fitter to find the needed EMBD documents on site quickly and efficiently.

Installation Resource Planning (IRP)

The IRP dashboard is our fulfillment resource planning platform that automatically extracts information from the IRP tool in real time. The dashboard visualizes several key business insights on different pages to maximize the installation planning efficiency and transparency of customer units installed by us and third-party / subcontractor fitters.

eCommissioning APP

This intuitive mobile application supports Schindler fitters when performing the on-site commissioning of a Schindler elevator. Helping to simplify the process by providing detailed guides – saving time and improving efficiency.

Lift Quality Check (LQC)

This application measures and reports the ride quality (vibrations and noise) of an installed elevator. The new app is enhanced with a backend SAP connection for retrieving the specific elevator data. The measurements can then be easily visualized on a corresponding Power-BI reporting dashboard.

Supply chain management – logistics and transportation

Supply chain management and procurement

We rely on a global network of suppliers for production materials and services. Our commitment to improve competitiveness, ethical behavior, and environmental management practices is embedded across our environment, quality, and vendor policies. We systematically evaluate our

prospective suppliers and conduct frequent requalification assessments for existing partners. In all markets we operate at a regional level, helping us source as locally as possible. The final assembly of our elevators and escalators takes place during installation at the construction site.

We implemented for the largest projects a global concept for carbon-neutral shipping. The measures taken include avoiding emissions on the main shipping routes through the use of biofuels.



Install – Schindler SLIM and CLIMB Lift

Save time and enhance safety

Schindler SLIM

The Scaffold-Less Installation Methodology (SLIM) is a flexible, safe, and tailor-made solution assured to meet the project specification. This allows you to have the building ready for market as early as possible. Increased flexibility, outstanding safety, and a reduction in installation time by up to 30% are just some of the essential benefits Schindler SLIM can bring to your next job site.

Customer benefits

- Work safety
- High independence and flexibility
- Reusable material
- Adjustable for all shaft dimensions
- Precise guide rail and door alignment
- Tailored solutions for individual jobsites

01	Crash deck
02	Guide Rail Installation Kit (GRIK) top frame
03	Material hoist
04	Suspension beam
05	Hoistway platform
06	Protective canopy
07	Hoistway entrance protection
08	Suspended platform
09	Pit set and lower GRIK frame



To support our effort to reach zero waste, we are reducing impacts from installation with the deployment of SLIM, our standardized process for installing products without scaffolding, which is made from wood, bamboo, or steel.

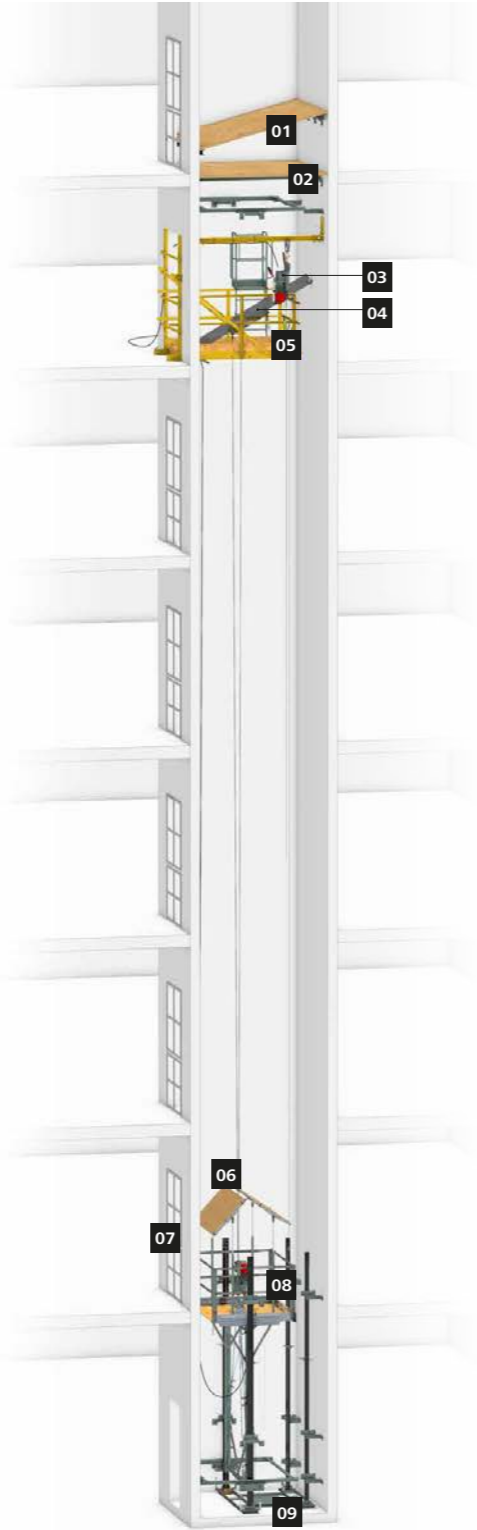

Schindler CLIMB Lift

Schindler CLIMB Lift is a certified self-climbing vertical transportation system that is used during the construction phase of the building. It provides an early vertical in-house transportation capacity, which allows the builder to move goods and people efficiently. Schindler CLIMB Lift offers the possibility to install your permanent elevator and equipment right from the start.

Customer benefits

- Early, fast transport capacity
- Improved site logistics management
- All-weather operation
- Earlier facade closing

01	Crash deck
02	Lifting platform
03	Installation platform (optional)
04	Machine platform
05	Elevator car



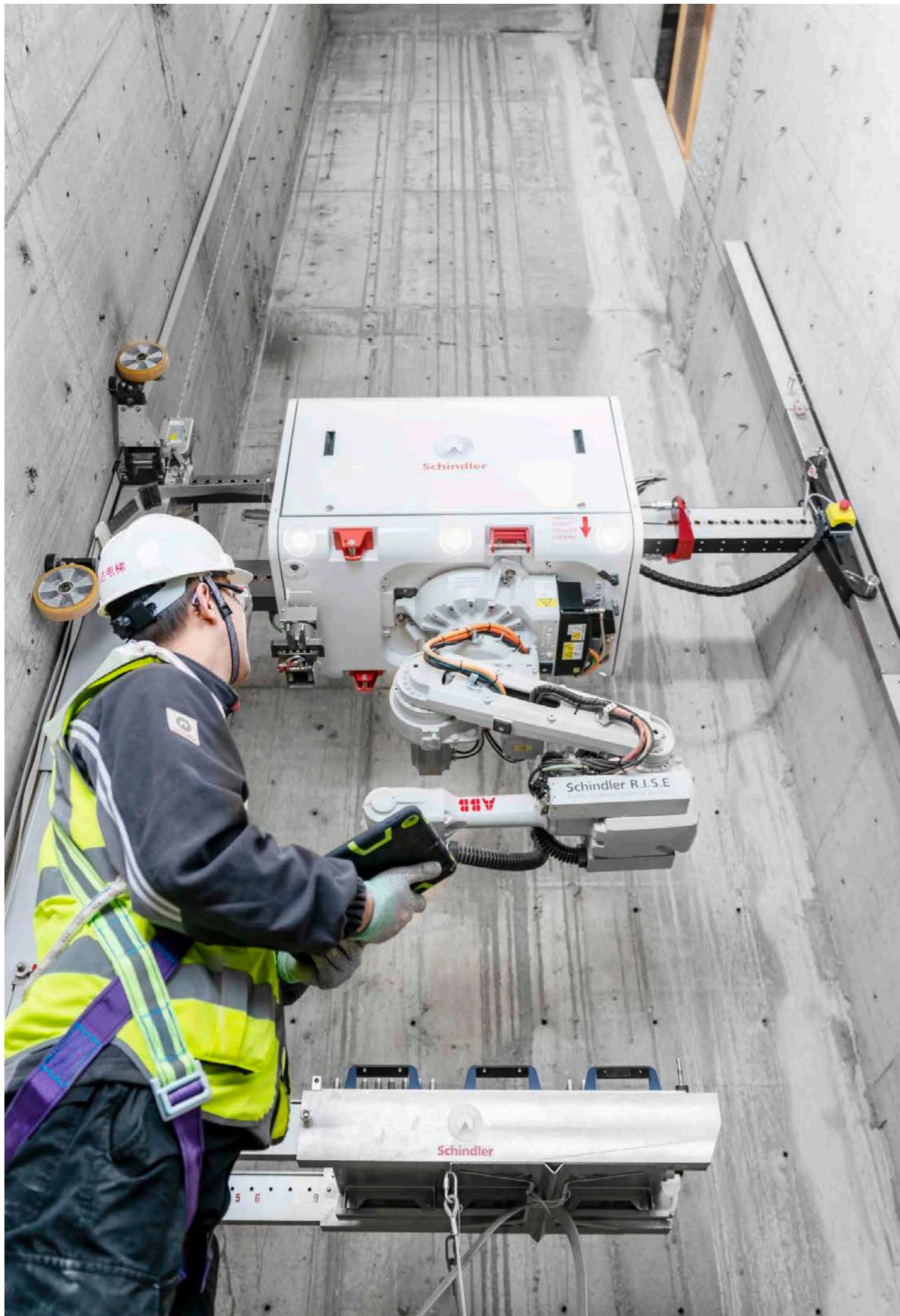

Install – Schindler R.I.S.E

Pioneering the future

Today, buildings are not only growing taller and wider, they are also growing faster. To address these increasingly challenging demands on installation schedules, we provide the fastest elevator installation method to date.

The revolutionary robotic installation system, Schindler R.I.S.E. This cutting-edge technology improves the safety & health for the installation force, while providing outstanding installation quality for you.

Robotic Installation System for Elevators (R.I.S.E)

We provide the fastest elevator installation method to date: the revolutionary robotic installation system, Schindler R.I.S.E. This cutting-edge technology improves the safety & health for the installation force, while providing outstanding installation quality for you.

Schindler R.I.S.E in action

The Schindler R.I.S.E system can complete a section of the hoistway, drilling and setting the anchor bolts required for the landing doors, divider beams, and guide rail wall

brackets, much faster than conventional installation methods. Three cameras are mounted onto the platform to allow remote viewing. Once commissioned, the system operates independently with no operator required.

Once installed in the elevator shaft, the autonomous Schindler R.I.S.E can operate around the clock. In case of an unexpected event, the Schindler R.I.S.E operator is contacted through the on-board WiFi. With Schindler R.I.S.E, the installation team is relieved from the physically demanding, repetitive and time-consuming tasks of drilling and setting hundreds of anchor bolts, which enhances safety in a taxing work environment.

Customer benefits

- Extreme accuracy
- Top-quality installations
- Removal of conflicts; improved planning with BIM integration
- Enhanced worker safety and health; removing non-ergonomic, repetitive, dusty, and noisy installation tasks
- Automated installation steps
- Incredibly efficient installation method for drilling and setting anchor bolts
- Highly attractive installation schedules for fast handover to customers



Phase **Operate & Maintain**

For the optimal transit operation

We enable efficient smart urban mobility: Elevators will play a more important role than cars in the sustainable cities of the future. Schindler PORT perfectly meets the challenge of efficiency and sustainability, enabling a seamless journey to your final destination.



Operate - Schindler PORT

Smooth and easy to your destination

Schindler PORT ensures your high-rise building is fit for the future. Optimizing efficient and sustainable transit performance, while also offering personalized service and access control.

The transit management system uses highly sophisticated algorithms. With Schindler PORT, the passengers are grouped and assigned to elevators by their destination

floor. In this way, the system can deal with significantly larger numbers of passengers and travel time to destination can be substantially reduced.

Customer benefits



Improved performance

Especially suited for large elevator groups or straight-line configurations in heavy-traffic commercial buildings, Schindler PORT can increase handling capacity by up to 25% and reduce travel time to destination by up to 30%.



Freedom and flexibility

With Schindler PORT, you have the potential to remove many of the existing constraints on interior layouts, allowing for greater freedom when designing the next generation of buildings.



Touchless operation

Schindler PORT offers different ways to travel through buildings without ever touching an elevator or even a door.



Schindler myPORT

With the unique smartphone app, Schindler myPORT, users can seamlessly, securely, and conveniently access and move through their building.

Energy savings The Schindler ECO Mode (Energy Control Option) continuously monitors the traffic conditions and keeps average wait times below or at the specified level, while saving as much energy as possible.

Sustainable operation Schindler PORT increases transportation capacity by up to 25% compared to conventional transportation.



Operate – Schindler PORT 4D

The comprehensive offering

Schindler Port 4D makes buildings even more appealing, eco-friendly and easy to access. It is the first holistic building traffic management system that enables seamless and secure transportation. Schindler PORT 4D takes 'time' into account as a fourth dimension, thereby unlocking new possibilities in buildings, and future building conversions, over the entire life cycle.

The Schindler PORT 4D stands for more than vertical transportation, it is a complete and holistic solution for architects, owners, and passengers. It adds comfort and convenience by taking into consideration every aspect of moving through a building. Through close collaboration with you, we ensure it meets

the demands for your building designs of today, tomorrow, and far into the future. Schindler PORT 4D combines new technologies with the proven capabilities of Schindler PORT, with features that are modular, personalized to individual users, and scalable across projects of any size.

The four thematic pillars of Schindler PORT 4D

Holistic

Schindler PORT 4D delivers a genuinely holistic solution during both design and operation.

Modular

Schindler PORT 4D was conceived for urban landscapes where buildings continue to evolve over a lifetime.

Personal

Our goal is to make each and every trip as pleasant as possible for our passengers. This is what makes a building great for everyone.

Collaborative

Schindler PORT 4D allows us to collaborate with you to realize even complex visions that require a range of different solutions.

Special features of Schindler PORT 4D

General Purpose Elevator System (GPES)

This newly developed application for Schindler PORT accomplishes absolute flexibility for you. GPES makes a total reconfiguration possible, even allowing building owners to completely transform the usage of selected floors.

Traffic Vision

This new simulation tool can be used to optimize Schindler PORT GPES and the traffic stream in a building over its entire life cycle. This can only be achieved by creating a 3D simulation of the entire building. Thanks to "Traffic Vision 4D", such a simulation is easier than ever.

Schindler PORT 4D enables up to 20% less waiting time. The integrated unique Schindler ECO Mode considers the ecological and operational status of an entire elevator system. This makes it possible to reduce the overall energy consumption by up to 40%.

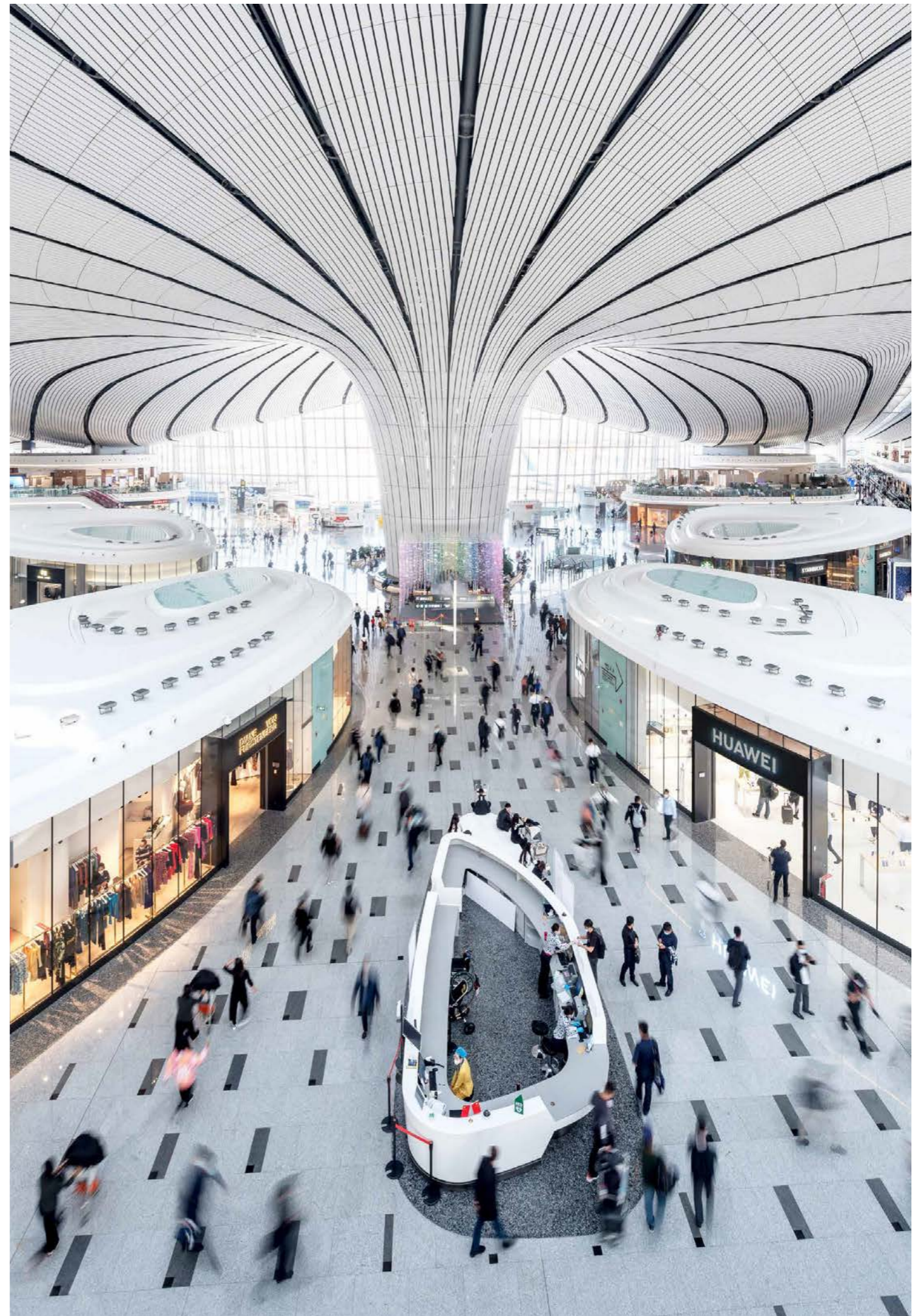



Operate – Schindler CoLab

Collaborative building integrations

In an everchanging world, we re-shape urban areas, combining new ways of living, working, and relaxing, all in the same building. We are taking the next steps to allow you to integrate our indoor mobility products and services into your digital building ecosystem via the Schindler CoLab integration toolbox.

Schindler CoLab building integration toolbox

Schindler CoLab is an open, secure, and modular building integration toolbox, covering on-site and cloud application programming interfaces, as well as software development kits. With our managed

service platform, you are never left alone; our experts are always at your side. We enable future-proof expansion and ensure a long-term successful collaboration with our customers.

User experience and seamless traffic

By integrating elevator, access, security, and robot systems, we can turn personal transit from a rather cumbersome process into a seamless one. Comprehensive platform integration enables a range of possibilities to make moving about a building more intuitive, safe, and enjoyable.

This category includes the following packages: Destination dispatch, robot building logistics, transit management, and the handling of people and goods data

Operation and maintenance

To ensure your system runs smoothly, it is essential to get the most out of any connected units. Performance, contractual, and operational information are continuously available (depending on third-party systems) and can be easily integrated into building management systems to improve processes, maximize uptime, and support facility managers in their day-to-day tasks.

This category includes the following packages: Essential status indicators, live visualization, maintenance information, notifications, and alerts, as well as operations profiles and modes

Entertainment and customization

Elevators are becoming communication platforms and integration through Schindler CoLab makes a higher degree of personalization possible. Passengers can set their preferences via an app and enjoy their desired content on in-car media screens, loaded and ready before the doors even open.

This category includes the following package: Content management (coming soon)



[Link to Schindler Developer Portal](#)
Schindler CoLab

Operate – Digital Media Services

Making elevator rides entertaining

The Internet of Things has opened up new ways to integrate digital products into urban mobility. Our digital media services make it possible to turn elevators into powerful communication platforms:

Information channels that can be serviced and managed from a single source. They can share spectacular entertainment and various information with the passengers. We are turning ordinary elevator rides into memorable experiences.

Schindler Ahead MediaScreen

This in-car media screen for elevators provides relevant information to passengers in real-time, with minimal effort and maximum recognition.

Schindler Ahead DoorShow

Passengers are enjoying the ride, before they even enter the elevator. The Schindler Ahead DoorShow displays information, advertising, and announcements directly on the elevator.

Schindler Ahead SmartMirror

The Schindler Ahead SmartMirror is both a mirror and a screen for entertainment or information. This new in-elevator multimedia experience will enhance your trip.

Schindler Ahead AdScreen

With the Schindler Ahead AdScreen, messages are delivered on a special screen inside the elevator to maximize the value of every elevator trip.

Linea 800 SmartTouch

A sleek and distinctive fixture. Passengers are greeted with exciting, relevant, and informative content that transforms the ride to their selected destination.



Linea 800 SmartTouch and Schindler Ahead MediaScreen

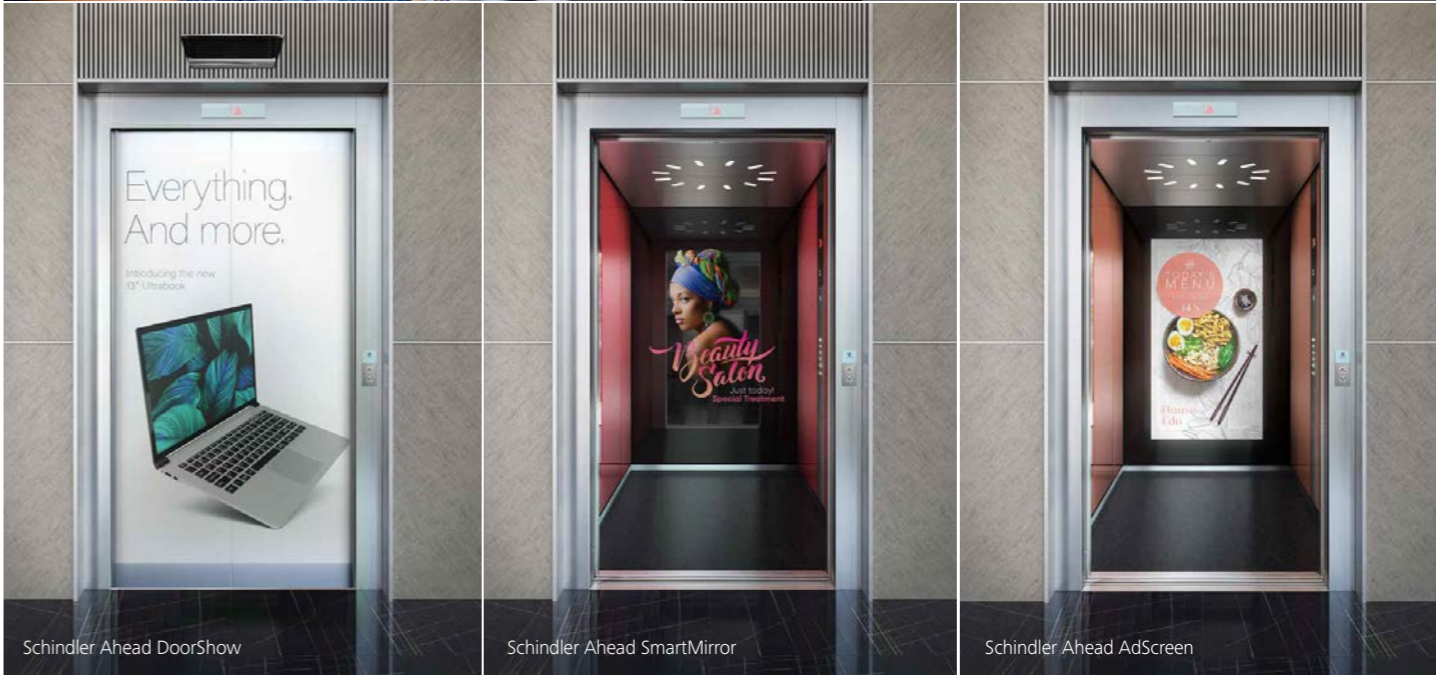



Maintain – essential services

Connectivity paves the way

Digital connectivity is the cornerstone upon which smart cities are built. Today, we already move more than 200 million people a day with digitally interconnected elevators and escalators.

Through maintenance and repair, we extend the lifetime of any elevator. With our digital services, we leverage the power of connected elevators to help ensure the reliability and the long-term health of your systems.

Innovations and new digital services, such as Technical Operation Centers (TOC) and/or adaptive maintenance, translate connectivity into specific actions to improve product performance.

Overview of the leading Schindler maintenance services (24/7)



Alarm button (in the car)

The alarm button provides a direct connection to the Schindler call center. The exact location is transmitted automatically, and the entrapped person is connected to an operator.



Technical Operation Center (TOC)

The TOC can intervene immediately via remote access. The center permanently monitors the functionality of the digital alarm systems and the infrastructure.



Adaptive maintenance

Adaptive maintenance provides a flexible maintenance scheme to ensure the maximum possible availability, offering modern maintenance based on real-time information from Schindler Ahead ecosystem.



Performance callback

The automated performance callback service provides auto-callback interventions based on a pre-defined event classification.

We deploy remote recovery and adaptive maintenance to make every trip count. Connectivity increases our remote maintenance capacities, helping us to avoid unnecessary trips.





 Phase **Modernize**

Update to the future

Introducing new technologies to reinvigorate existing buildings is the essence of effective modernization. Not only do they add new appeal, but they generate genuine value for building owners as well.



Modernize – smart elevator upgrades

Get ready for the future

Our modernization approach keeps passengers moving. Our proven products and installation processes can help improve the reliability, performance, safety, comfort, and esthetics of your elevator.

Modernization also protects your investment in the long-term. We can upgrade any installation and/or traffic control systems to meet the passenger requirements and to comply with regulations. We replace whole systems (replacement) or provide step-by-step modernizations (transformation), by upgrading specific parts.

Transformation

With a transformation, the problematic areas of your elevator system can be addressed first. In the shortest down time, we can achieve the upgrading either by replacing single components or by applying packages.

Replacement

With a total replacement, a brand new and latest code-compliant elevator is installed into the existing hoistway. With our replacement, you get all the benefits of a new elevator while working within the existing available space.

Customer benefits

- Latest safety requirements
- Optimized traffic in the building
- Greater energy efficiency
- Schindler CleanMobility application
- Advanced engineering in Swiss quality
- An improved ride experience
- Modern car design
- Smoother building operation management
- Increased uptime

For existing buildings, our modernization solutions can significantly improve the energy efficiency of the original elevator. Modernization with us includes regenerative drives, intelligent power management systems, the installation of LED lighting systems, and energy-efficient dispatch systems that optimize traffic stream and provide ways to increase capacity while reducing energy consumption.



Modernize – precisely customized

Choosing the perfect path

We offer phased modernization with a high degree of flexibility and adaptability to building operation criteria based on your readiness and budget.

Sometimes, upgrading elevators while retaining an existing machine in good condition can be a good alternative to a total replacement. Assuming the existing machine is in good condition and properly maintained, it can be retained by upgrading to a modern drive and control system. With this upgrade, the latest safety and energy efficiency standards will be ensured at the same time. Downtime during the modernization can also be significantly reduced.

Phased modernization in two stages

Stage 1 Upgrading the control system: This can boost traffic handling capacity and ride quality immediately.

After these upgrades, the elevator system will be as good as new. Our products comply with the latest EN81-20/50 code and entail down-ward compatibility. This allows you to harmonize the modernized and current systems seamlessly.

Stage 2 Replacing the existing machines and other components.

Schindler PORT Overlay Modernization made seamless and easy

Following the vision of making modernization work as unobtrusive as possible for the building occupants, we developed Schindler PORT Overlay Modernization.

The modernization is performed without disrupting service or inconveniencing the building occupants.

This ingenious modernization method capitalizes on the ability of Schindler PORT to instantly boost the overall traffic performance of elevators. This makes it possible to individually take out elevators for transformation and return them to service seamlessly.

Once Schindler PORT Overlay is in place, your elevators can handle more traffic than ever before, even as individual cars are still being modernized.

Schindler PORT Overlay is compatible with most elevator control systems. The proven technology has been successfully deployed in countless installations worldwide.





We Elevate... High-rise solutions

For more detailed information about our different solutions, please contact us:

Schindler Elevator Ltd. | Global Large Projects
Zugerstrasse 13 | 6030 Ebikon | Switzerland
Phone + 41 41 445 31 31

Schindler (China) Elevator Co., Ltd. | Global Large Projects
No. 555 Xingshun Road | Jiading District | 201815 Shanghai | China
Phone + 86 21 6709 6666

globallargeprojects@schindler.com
largeprojects.schindler.com

This publication is for general informational purposes only and we reserve the right at any time to alter the product design and specifications. No statement contained in this publication shall be construed as a warranty or condition, expressed or implied, as to any product, its fitness for any particular purpose, merchantability, quality or shall be interpreted as a term or condition of any agreement regarding the products or services contained in this publication. Minor differences between printed and actual colors may exist.
Copyright © 2021 Schindler Aufzüge AG

We Elevate



Schindler